

COMPLETE SOLUTIONS FOR SEAMLESS INTEGRATION OF CONTROLS & CONTROLLABLE PRODUCTS

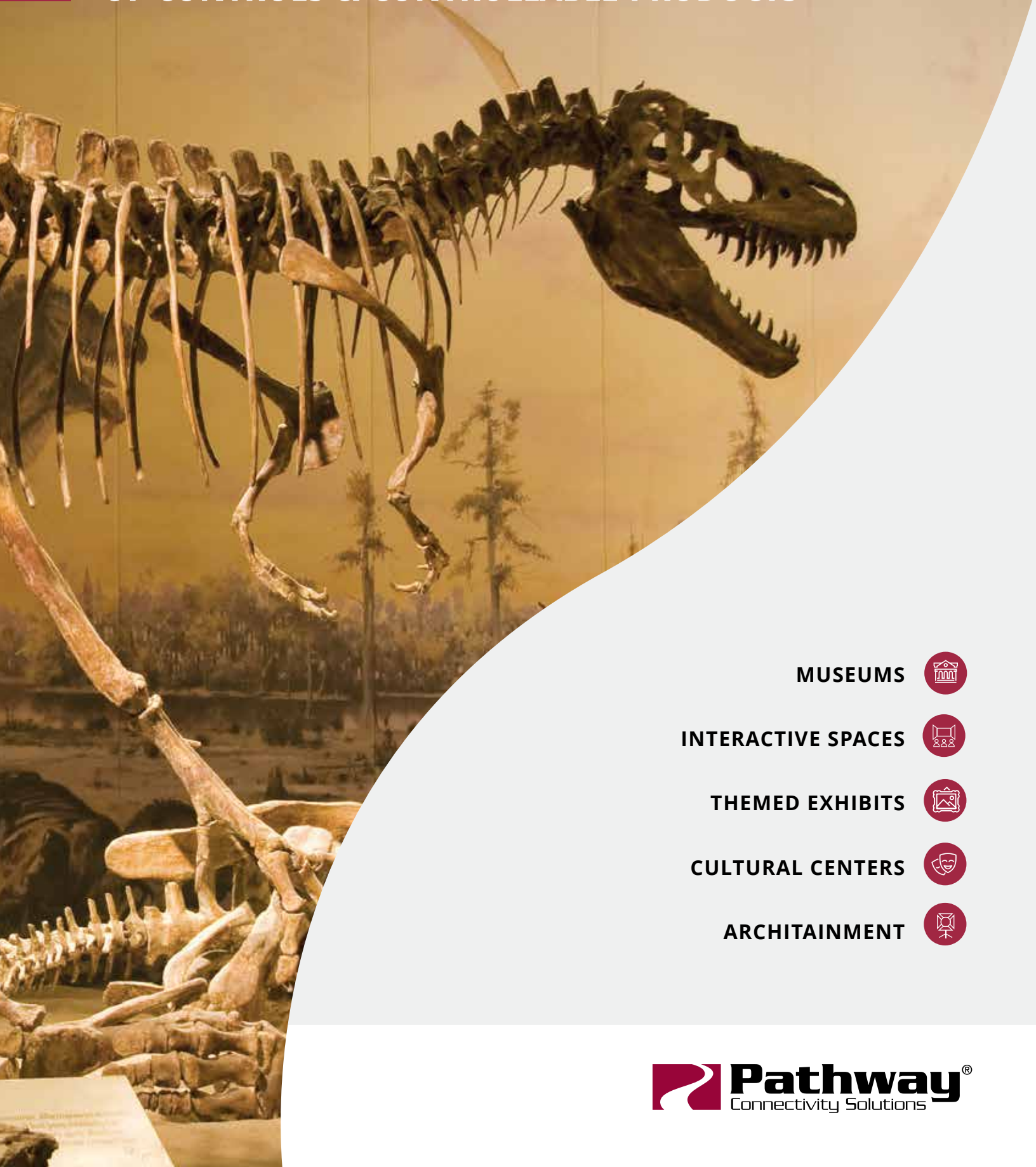

MUSEUMS



INTERACTIVE SPACES



THEMED EXHIBITS



CULTURAL CENTERS



ARCHITAINMENT



PATHWAY CONNECTIVITY

PRODUCTS USED IN THESE APPLICATIONS MAY INCLUDE



COGNITO²

The theatrical controller that delivers up to four DMX512 universes using Task Oriented Navigation and Natural Language Control.



VIA5

The entertainment class PoE gigabit switch that connects and powers the controllers, remote stations and gateways.



CHOREO

All the power of Cognito² and designed to fit a 3-gang wallbox, a 19" equipment rack or a tabletop console.



eDIN 1003

Is an extremely versatile DMX512 to contact closure interface. Twelve double-throw isolated 2-amp relays with 9 operating modes for sophisticated control of shades, curtains, low voltage devices and signal level switching.



CHOREO NSB

PoE button and sliders that can command memories and macros on multiple controllers. Decora® form factor modules that can be arranged in one to six gang faceplates.



eDIN 1006

The industry's most powerful analog to DMX512 interface. Twenty four inputs serve as on-ramps for contact closure and sourced 0-10v signals to the control network.



eDIN 1009

An essential building block in modern DMX512 distribution systems. Five bi-directional ports support E1.20 RDM responders and cascaded system layouts.



SNAP

An enclosure designed for today's modern general illumination lighting fixtures that require intelligent management of power and 0-10v control signal distribution.



PATHPORT 1014

A compact PoE gateway for encoding, routing, decoding and merging DMX512/RDM data over an Ethernet lighting control network.

SYSTEM APPLICATIONS NOTES

REFER TO ONE-LINE SCHEMATIC

- A** In this application, **Choreo** is performing several functions. First and foremost, Choreo is the master system processor where programming and playback for each space in the venue is managed by show control input and time-clock control. Choreo is also the master control point for manual system override and temporary event programming. Multiple Choreos can be stacked to power larger systems. Choreo can be mounted in a three-gang wallbox, a 19" equipment rack or in a desktop consolette.
- B** **Cognito²** is the hands-on live-action lighting console for the theater space in this venue. Multiple show files can be programmed and stored for regularly scheduled or special events. Note that Cognito² is also capable of sending and receiving show control I/O. Cognito² can be temporarily located in any space in the venue and used as the programming tool for show files to be stored in Choreo. Cognito², powered by an external PSU or by system PoE, is designed for table top use (standard) or to be installed in a 19" equipment rack.
- C** **VIA5** lives at the very heart of the Pathway Connectivity ecosystem. An entertainment class Gigabit Ethernet switch with advanced management features that support distribution of streaming data for audio, video and lighting control applications. VIA5 mounts on 35mm DIN rail and sources power to all the PoE devices in the system including Cognito², Choreo, Choreo NSB and the Pathport gateways. Multiple switches can be distributed throughout the venue.
- D** **Choreo NSB** stations are an industry first; they are PoE powered. Traditionally, a single master system processor polls all the remote stations to check for button pushes or slider movement. In this system architecture, each button and each slider is a unique network entity. Button #1 can operate a memory or trigger an action on one controller and slider #4 can do likewise on a second - or third - controller. Alternately, Choreo NSB can snapshot and replay four DMX512 universes of E1.31 Streaming ACN.
- E** The **eDIN 1006** card is a multi-mode Analog to DMX512 interface. In this application, it is used to receive contact closure inputs from a variety of devices, convert them in to DMX512 signals that are then routed to the Choreo controller (it could be multiple Cognito² or Choreo controllers) where the input triggers recorded memories or other actions.
- F** The **eDIN 1003** card is a multi-mode DMX512 to Contact Closure interface. In this application, it is used to control a set of motorized window shades from Choreo and/or Cognito².
- In other operating modes, applications include, but are not limited to maintained or momentary relay actuation. The 1003 can perform analog or digital data signal switching that will enable or disable downstream devices in response to cued or scheduled commands from the controllers.
- G** The **Pathport 1014 Gateway** is one of three DIN mountable DMX512/RDM-over-Ethernet gateways in our product line. One and two port gateways are also available. In this application, control data sourced from the Cognito² and Choreo controllers is routed to DMX512/RDM end devices throughout the system. A single port on a gateway can be programmed to output a unique universe of DMX512 built using control data from eight different controllers and either merged HTP or have a priority scheme invoked. Other ports can be configured to receive DMX512 and route that in the network to trigger actions in the controllers or merge with other DMX512 outputs.
- H** The **eDIN 1009** card is a 4-port bi-directional DMX512/RDM Splitter. The THRU port supports a cascade of splitters to be installed in very large scale systems. Even when the fixture schedule does not include E1.20 RDM responders, it is good design practice to use the 1009 card as the standard splitter because each port is fully isolated and future system upgrades could make use of E1.20 RDM responders.
- I** Small and compact, **eDIN System Enclosures** enable systems to be built in bespoke configurations including VIA5 switches, eDIN interface cards and/or the DIN-mountable Pathport gateways. In this application, controllers and control interface devices are distributed throughout the venue and the need for bulky 19" equipment racks is eliminated.
- J** Pathway Connectivity manufactures a complete line of **Modular Data Receptacles** used to connect plug-and-play devices to the system infrastructure. It is another way that we provide single-manufacturer accountability for everything from the controller, to the Ethernet switch, to the remote stations, to the gateways, and even including the simple wall plates. With PoE, devices like portable gateways, controllers or wall stations don't even need a power supply brick.
- K** The **SNAP Lighting Control Panel** manages DMX512 control of single-pole line-voltage relays and analog control channels that source or sink 10VDC. Listed for UL924 applications, SNAP features a fully flexible soft patch as well as maintained and momentary contact closure inputs for integration with fire alarm, security and power transfer systems.

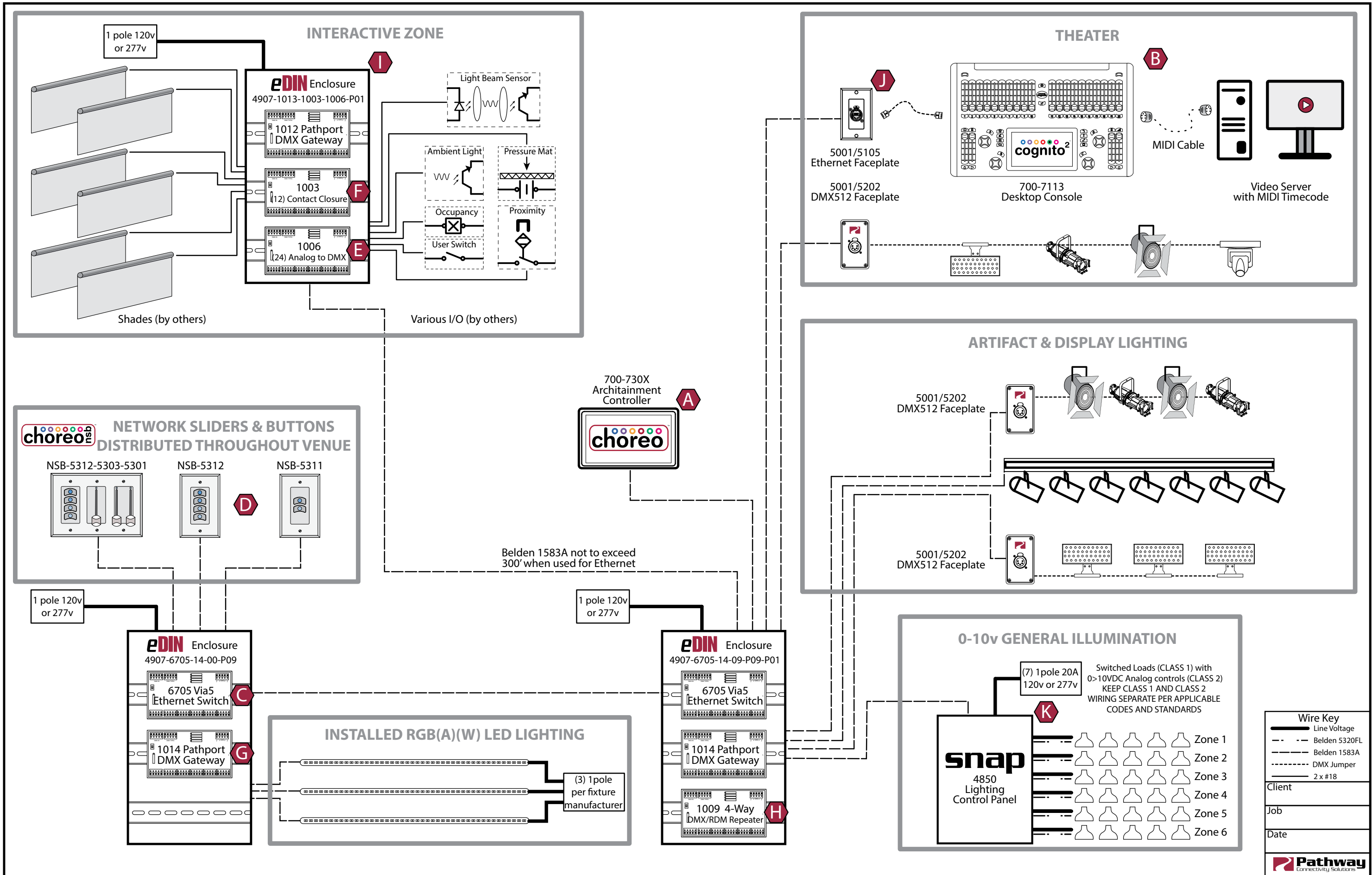



A pioneer in entertainment lighting, Pathway Connectivity is renowned for solid, easy-to-use equipment with comprehensive, robust features.

Our reputation for innovation and reliability is based on over thirty years commitment to enhancing the functions and interoperability of lighting systems around the world.

For demonstration and training videos, visit our Pathway Connectivity YouTube Channel at www.youtube.com/pathwayconnectivity

#103-1439 17 Avenue SE

Calgary AB Canada T2G 1J9

T 403.243.8110

F 403.287.1281

pathwayconnect.com